

Swansea GGP - National Fire Chief's Council (NFCC) Fire Safety Compliance

Drawing No.	NFCC Guidance	Compliant	Notes
1	Battery storage systems should be designed to prevent fire, including appropriate detection, control and mitigation measures.	Yes	Battery storage containers will be equipped with industry recognised safety systems including: BMS, Fire Detection System, Explosion Prevention and 24/7 Remote Monitoring.
2	Site should include two access routes to accommodate varying wind conditions.	Yes	Site can be accessed via two vehicle gates entering from the north or east boundary.
3	Site road networks should provide unobstructed, access to all site areas and suitable to accommodate fire service vehicles.	Yes	Fully interconnected roadways permit access to all site areas. Swept pass analysis completed for fire service vehicles.
4	Site should include a perimeter road with suitable passing places.	Yes	Perimeter road encircles site, fully interconnected roadways enable multi-vehicle access and maneuverability.
5	Spacing of battery units should be 6m unless a clear, evidence based, case for the reduction is shown.	Yes	Battery units will be spaced with minimum separation 2.6m. NFCC recognised UL9540A testing will be undertaken to demonstrate suitability.
6	Spacing of battery units should be 25m from site boundaries prior to mitigation. Reduction may be possible in areas of lower risk (e.g. rural settings).	Yes	Battery units will be spaced > 25m from the site boundaries in most locations. Site location in rural setting. BESS protection features and intended UL9540A testing considered suitable mitigation.
7	Spacing of battery units should be 25m from occupied buildings.	Yes	Site does not include occupied buildings, and there are no occupied buildings within 25m of the site boundary.
8	Areas within 10m of BESS units should be cleared of combustible vegetation.	Yes	Vegetation will be cleared with 10m of all battery units.
9	Firewater supplies equivalent to 1,900 L/min over 2-hours	Yes	Two (2) water tanks will provide 228,000 L emergency firewater supplies capable of 1,900 L/min flow over 2-hours
10	Suitable environmental protection measures should be provided, including systems for containing and managing water runoff.	Yes	Sustainable drainage system (SuDS) and attenuation ponds will be provided with TBC L capacity to capture any contaminated firewater runoff for safe disposal.

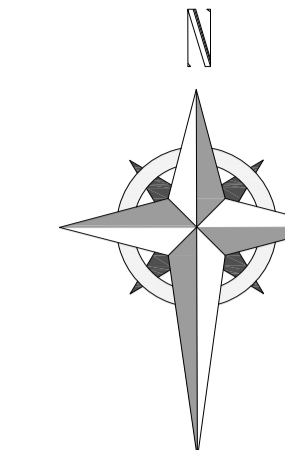
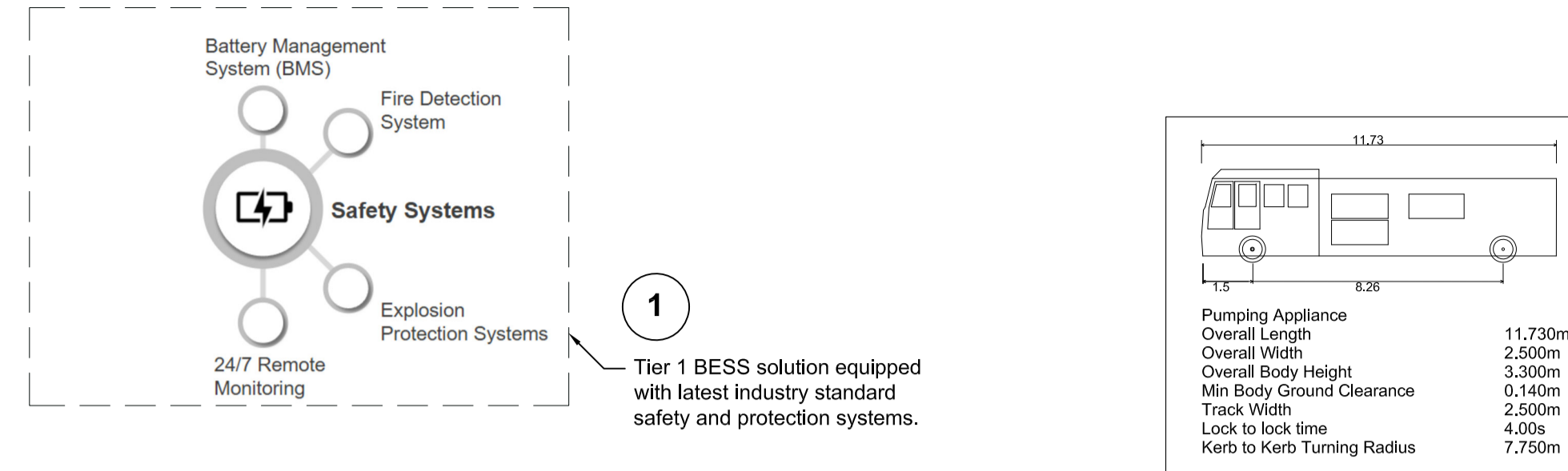

This drawing is the copyright of STATKRAFT UK Limited and must not be reproduced in whole or in part or used in any manner without their written permission. Scaled dimensions must not be taken from this drawing. All dimensions are to be confirmed on site prior to commencement of work.

Revisions:

Revision	Date	Revision Notes	Drawn	Inspected
01	07.02.25	First Issue	CS	TM
02	13.02.25	Fire Truck & Swept Path Amended	CS	TM

LEGEND:

--- (Red dashed)	30M OFFSET FROM BOUNDARY
--- (Green dashed)	10M OFFSET FROM VEGETATION
--- (Blue dashed)	45M HOSE COVERAGE (HYDRANTS)

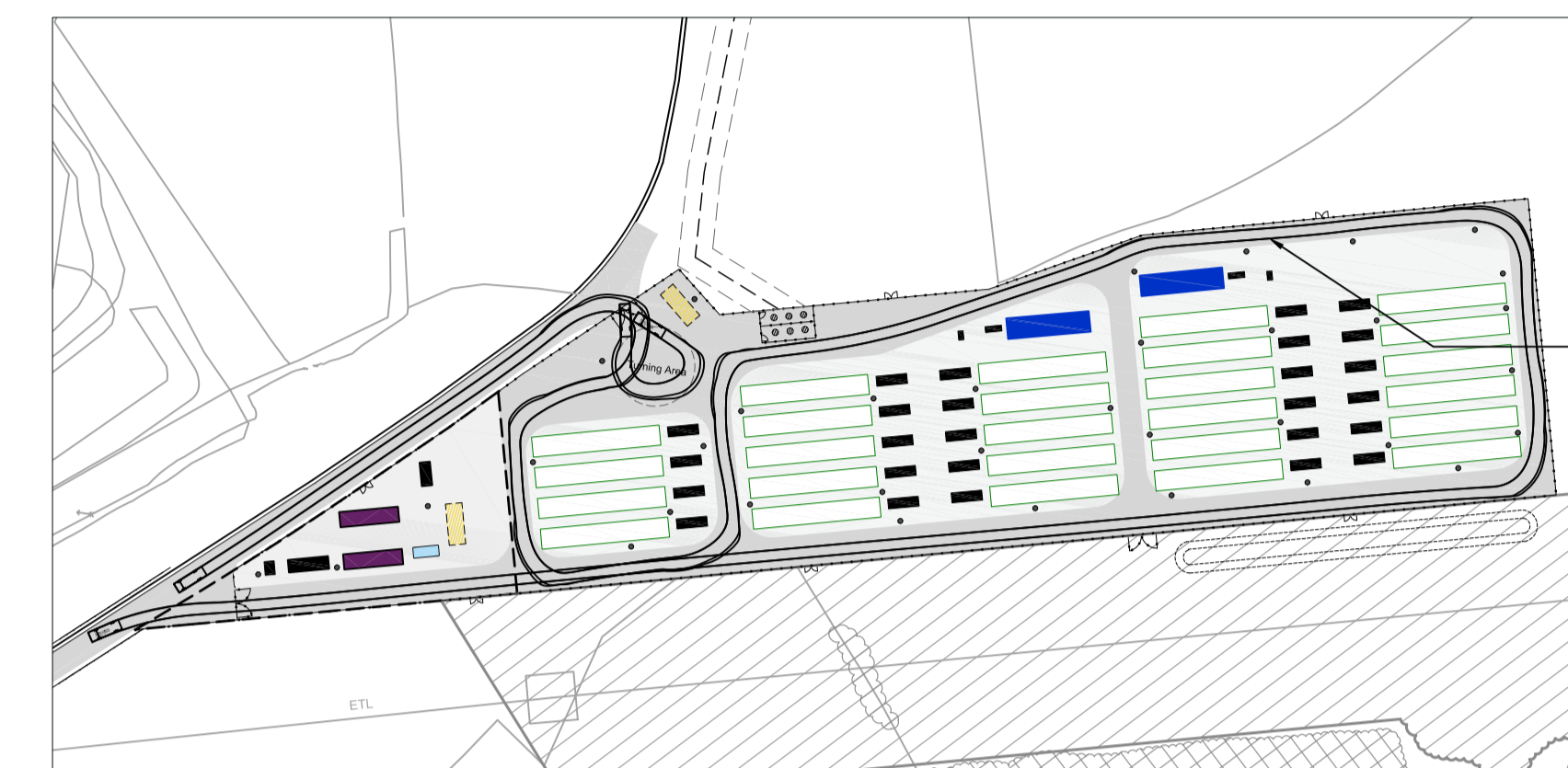

Enlarged view: Swept Path analysis for Emergency access

Scale: NTS

SWANSEA BESS SITE HAS BEEN DESIGNED IN CLOSE ACCORDANCE WITH THE RECOMMENDATIONS SET OUT BY THE FIRE CHIEF COUNCIL AND IN PARTICULAR WITH REFERENCE TO THE DOCUMENT 'GRID SCALE BATTERY ENERGY STORAGE SYSTEM PLANNING - GUIDANCE FOR FRs' THE PURPOSE OF THIS PLAN IS TO DEMONSTRATE THE CONSIDERATIONS AND COMPLIANCE OF THE DESIGN WITH THIS GUIDANCE.

THIS PLAN TO BE READ IN CONJUNCTION WITH THE PROPOSED SITE LAYOUT PLAN REF: PROPOSED SITE LAYOUT

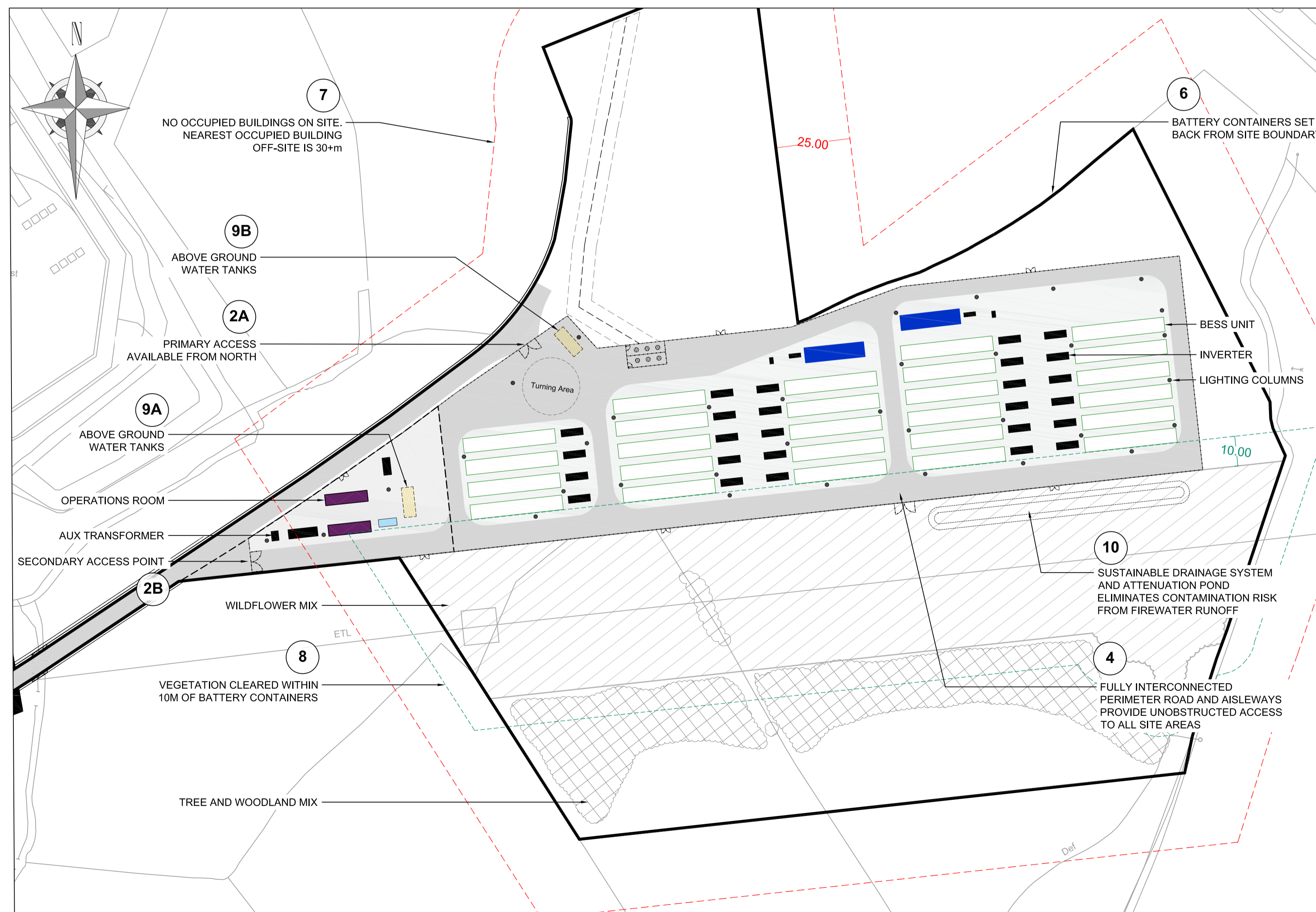

Fire Strategy Plan

Scale 1:500

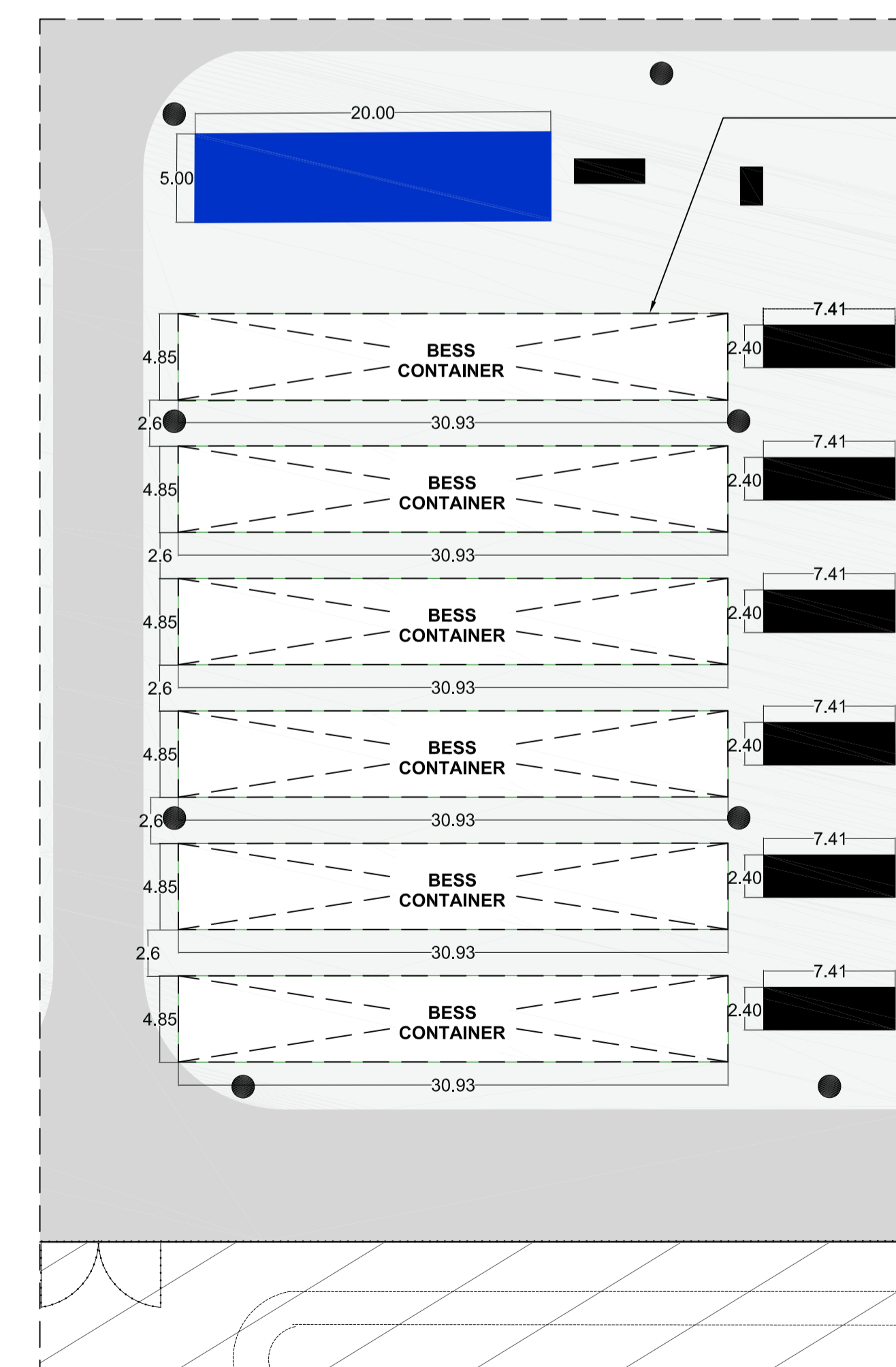
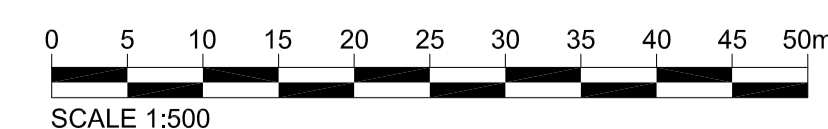

Enlarged view: BESS Storage Spacing

Scale: NTS

Project:

Swansea Bess



Statkraft UK Ltd.
19th Floor, 22 Bishopsgate
London, EC2N 4BQ
Tel: +44 (0) 20 7549 1000

Drawn by:



CADmando Design & Drafting Solutions Ltd
Unit B2, The Courtyard, Severn Drive, Tewkesbury Business Park, GL20 5GD
Tel: +44 (0) 1884 850919
Mob: +44 (0) 7514436919

Status:

PLANNING

Drawing Title:

**Swansea Bess
Fire Strategy Plan**

Drawn: CS Checked: TM First Issued: 07.02.2025

Project Code: STA009- Drawing Number: FS-01

Sheet Size: A1 Scale: A.N Revision: 02