

Consented Swansea  
Greener Grid Park (GGP)  
- Under Construction

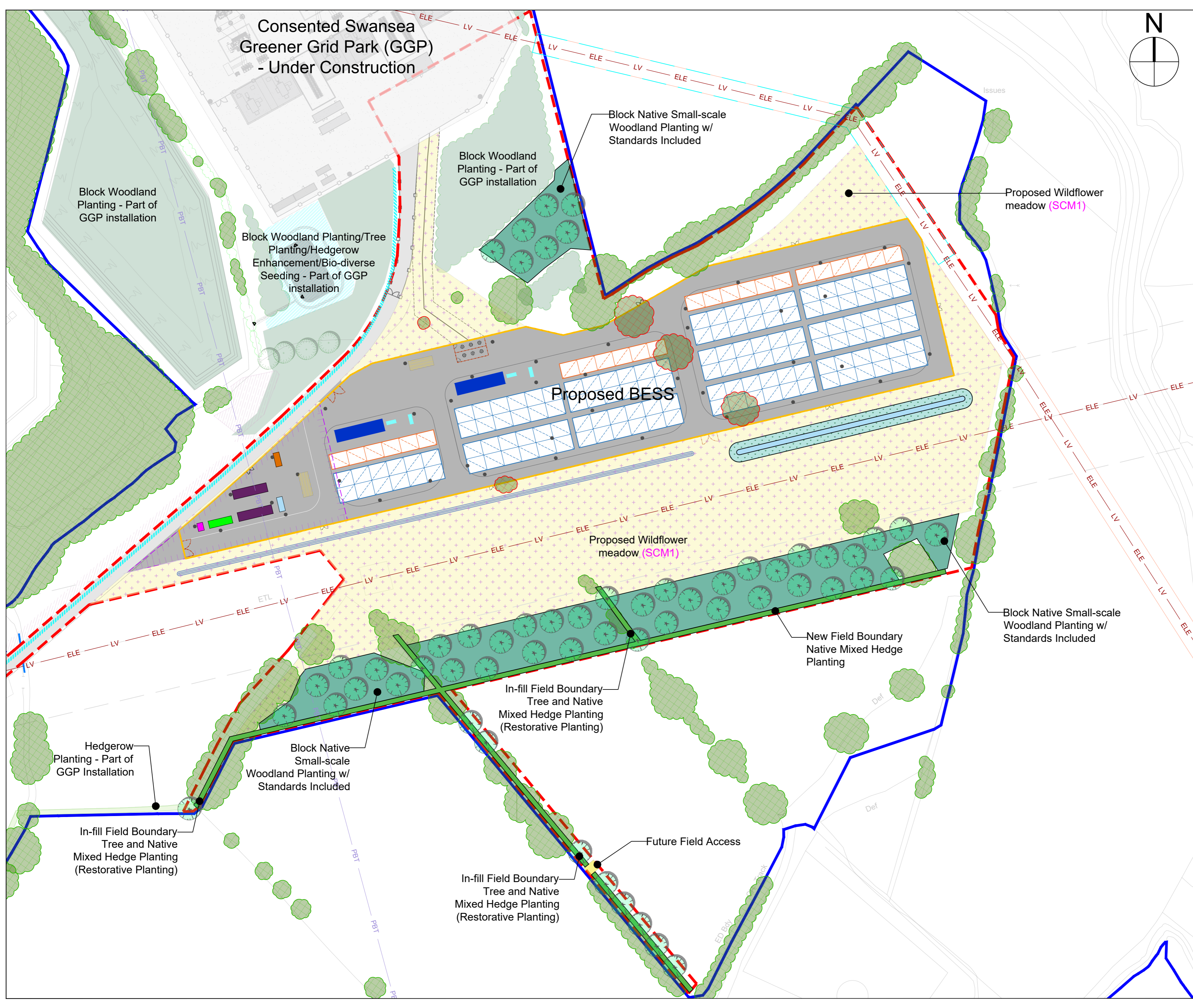

**Legend**

- Site Boundary
- Ownership Boundary
- Existing Overhead Cable Route
- Existing Telecom Route
- Watercourse
- Proposed Security Fence
- Existing Woodland/Tree retained and maintained
- Removed Tree Material
- Proposed Native Woodland Mix planting\* (W1)
  - Betula pendula
  - Corylus avellana
  - Crataegus monogyna
  - Fagus sylvatica
  - Quercus robur
  - Salix caprea
- \*with Woodland Meadow Mix seeding underneath (SCM3)
- Proposed Native Wildflower Meadow (SCM1)
- Proposed hedge/in-fill planting
  - Corylus avellana
  - Crataegus monogyna
  - Ilex aquifolium
  - Lonicera periclymenum
  - Prunus spinosa
  - Sambucus nigra
- Proposed SuDS
- Proposed Native Wetland Meadow (SCM2)

Rev E 07.04.2025 - Road alignment / Woodland spec. / Field access corridor  
Rev D 27.03.2025 - Hedge spec. /Update areas per Ecol.  
Rev C 25.03.2025 - Insert Site Plan w/ moved BESS and new RLB  
Rev B 24.02.2025 - Alter base map/GGP site; Reinforce NMA Hedge.  
Rev A 17.02.2025 - Alter base map/GGP site; Remove access wayleave; Alter plan colours/legend; Add plan notation (GGP landscape).

**TGP LANDSCAPE ARCHITECTS**  
Suite 1.01, 142 St. Vincent Street,  
Glasgow, G2 5LA Tel: 0141 429 2999  
info@tgp.uk.com/www.tgp.uk.com  
Also in Edinburgh & Newcastle

Project		Swansea GGP Extension			
Title		Landscape Mitigation Masterplan			
Date	Scale	Drawn	Checked		
17/02/25	1:1000 @ A2	CL/RPD	NH		
Job	Suitability	No.	Issue	Revision	
2242	-	L01	-	B	
LI WORKSTAGE: 0/1   2   3   4   5   6					
<div><input type="checkbox"/> <input type="checkbox"/> <input checked="" type="checkbox"/> <input type="checkbox"/> <input type="checkbox"/> <input type="checkbox"/></div>					

**DISCLAIMER:**  
Do not scale from this drawing.  
All dimensions to be verified on site prior to commencement of works.  
Drawing to be read in conjunction with related TGP drawings, consultants drawings and any other relevant information.  
This drawing is the copyright of TGP Landscape Architects Ltd. unless otherwise specified.