

Terminals:

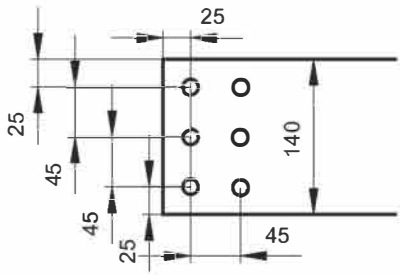

Hole diameter: 14 mm  
Thickness: 10 mm  
Material: Aluminium  
Max. mech. static loads:  
- axial: 1400 N  
- radial: 1400 N  
- lateral: 420 N  
- higher forces possible upon request

Min. center-to-center spacing:  
Dcc=3600 (magn. constraint)

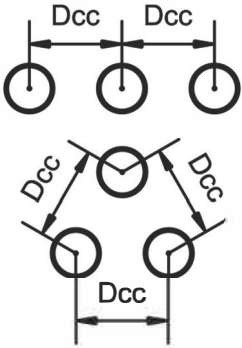

Detail: earthing connection

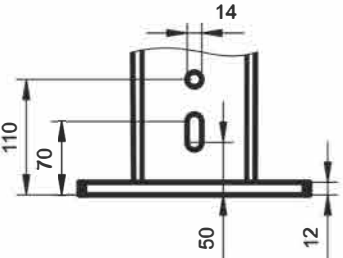

Detail: mounting base

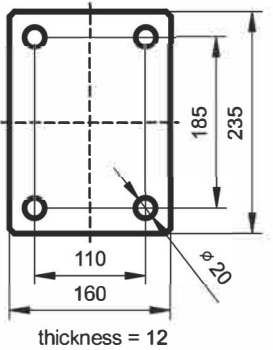

K10109-A010-00 b3bd66e1

Technical Data:	
Rated voltage	15 kV
BIL (to ground)	95 (95) kV
Fundamental frequency	50 Hz
Rated inductance	0.38 mH
Nom. fundamental current	2500 A
Max. rms current incl. harmonics	2500 A
Therm. short-circuit current	25.5 kA rms/ 1 s
Mech. short-circuit rating	65.03 kA peak
Total mass	560 kg
Surface treatment	HP ins. varnish
Color	RAL 7040

Notes:  
© This drawing is copyright and may only be reproduced with the designer's permission.  
Layout and template are not to be changed in any way.  
All dimensions are in meters, unless specified otherwise.



Statkraft UK Ltd  
19th Floor, 22 Bishopsgate, London, EC2N 4BQ

+44 (0)20 7549 1000  
www.statkraft.com

Project Name: Swansea Greener Grid Park  
Extension

Drawing Title: Air-core Reactors

Drawing No: SWAB-DM-XX-00-DD-XX-20

Scale: not in scale	Page size: A3	Revision no. 00
Drawn by: RC	Check by: WKC	Date: 24/03/2025

MAGNETIC CLEARANCE PER PHASE

The space within the magnetic clearance contour, prescribed by RMC1=1390 and HMC1=510 shall not contain metallic parts. For larger metallic structures, such as concrete rebar, grounding wiring and fencing the distances RMC2=1730 and HMC2=1020 should be kept. Conductive loops surrounding the reactor in most cases should be avoided and electrical clearances to conductive parts must be maintained. Special attention should be paid to the proper functioning of electric devices in the vicinity of the reactor such as in accordance with EN 61000-6.

Coil Innovation GmbH  
Nikola-Tesla-Strasse 1  
A-4070 Eferding  
t: +43(0)7272 75200



Tolerances	Edges
DIN ISO 2768-sg	DIN ISO 13715

				Measures i nmm		
				Des.	Date	Name
					16.12.24	Eb
No.	Revision	Date	Name	Check	16.12.24	Ag

Preliminary Outline Drawing  
(do not use for foundation or anchor bolts design)

Customer: Statkraft UK Ltd  
Project: 15kV CLR

Type: CL-0.38/2500/95  
side-by-side  
Current Limiting Reactor

CI drawing number:  
K10109-Z010-00